

CORTE TRANSVERSAL SEÇÃO A
TRECHOS 1-4

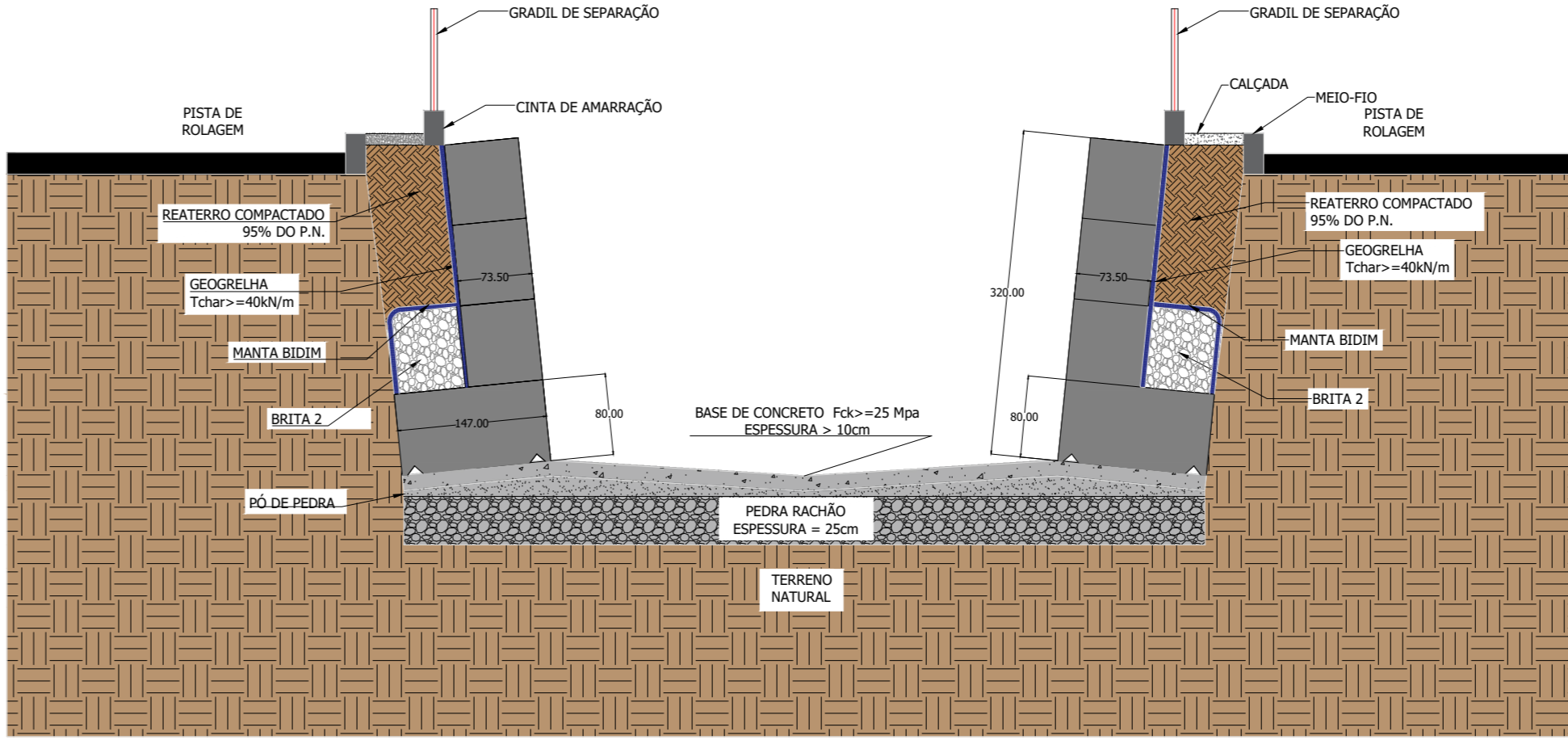

CORTE TRANSVERSAL SEÇÃO B
TRECHOS 5-12

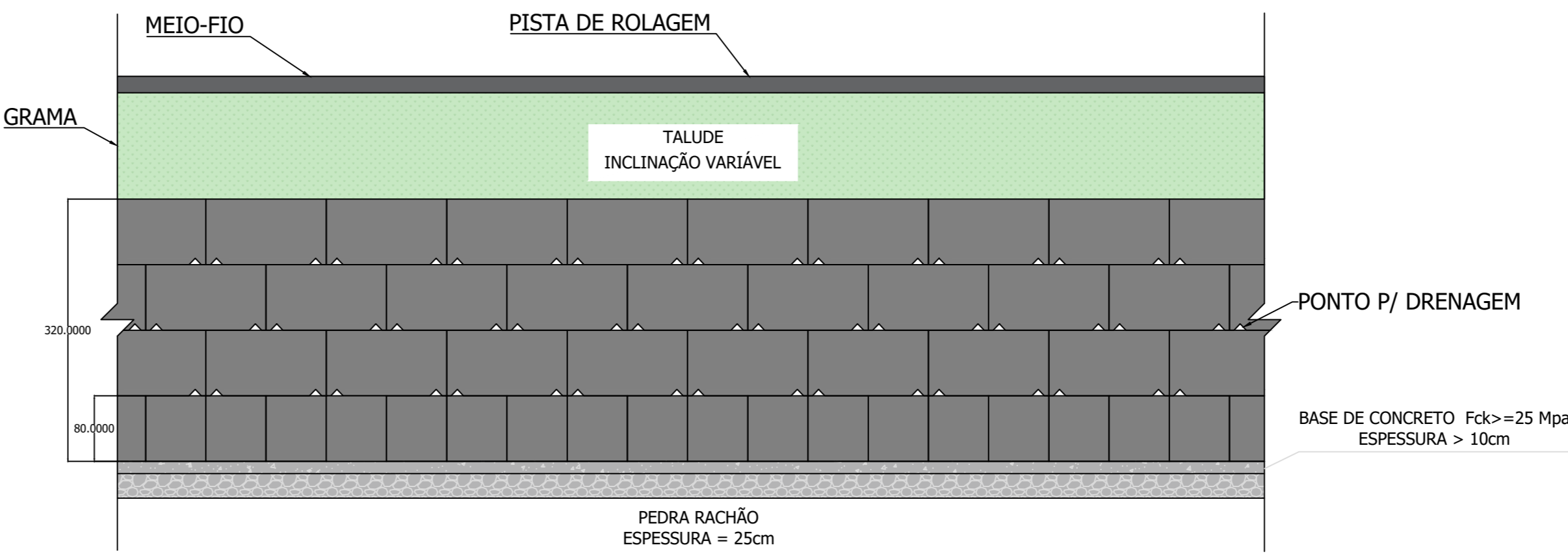

CORTE/VISTA LONGITUDINAL SEÇÃO A
TRECHOS 1-4

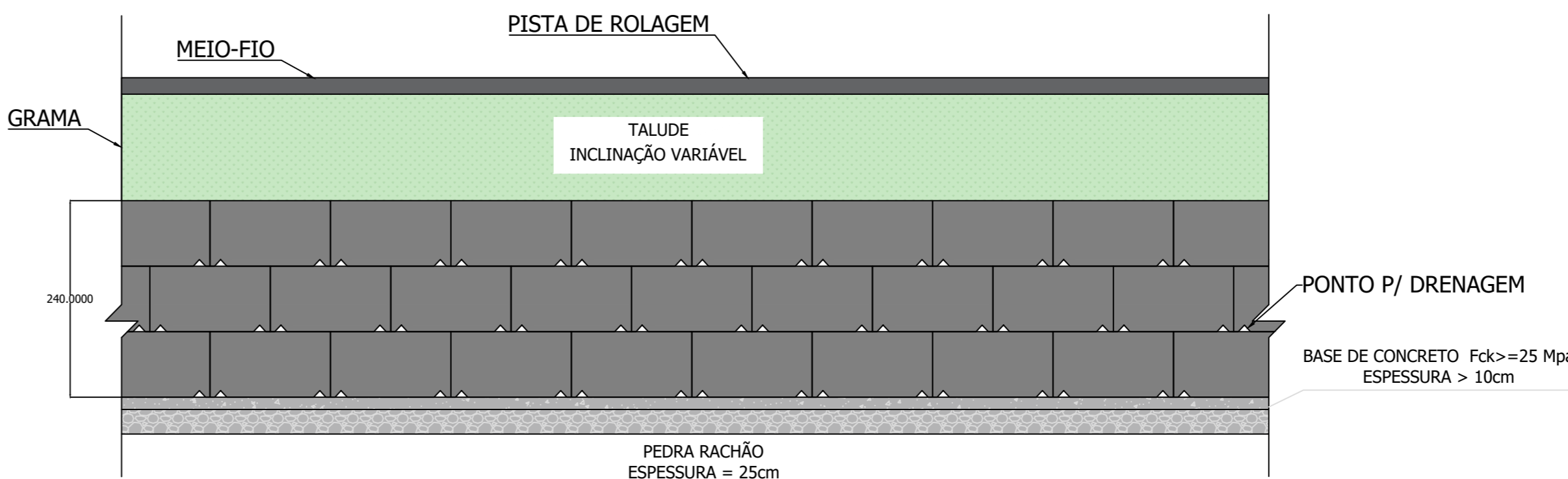

CORTE/VISTA LONGITUDINAL SEÇÃO B
TRECHOS 5-12

DIMENSÕES

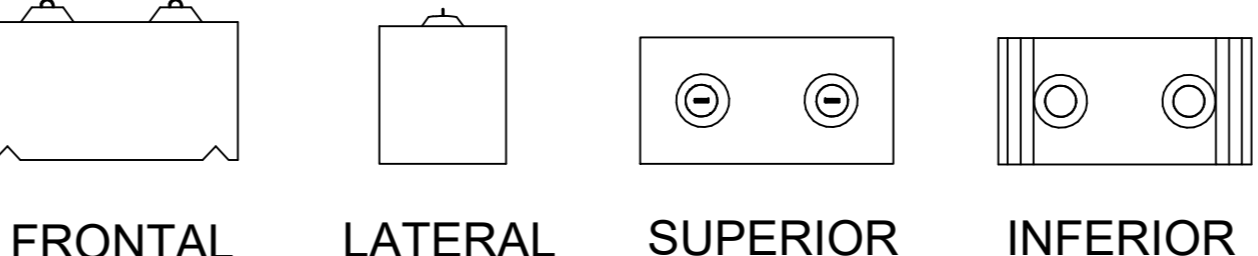
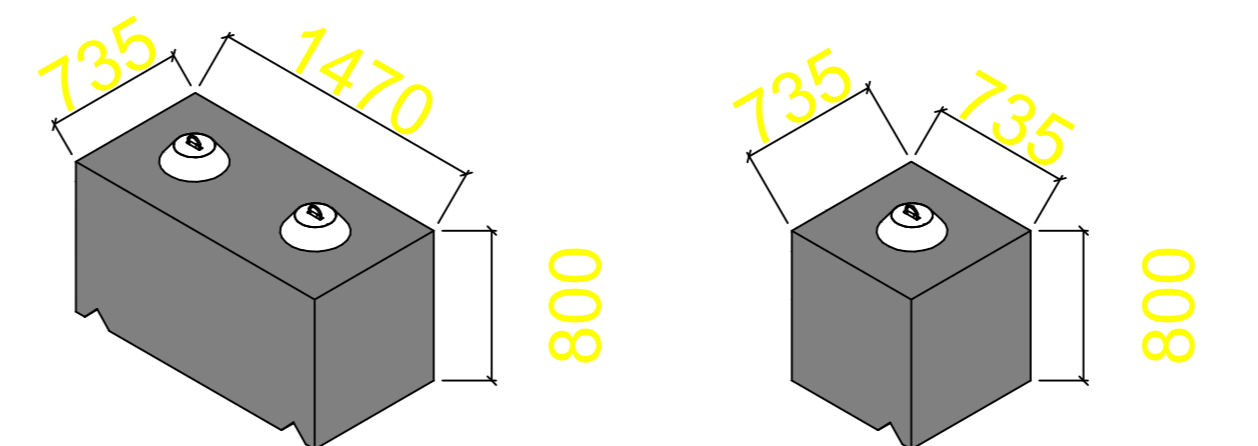

PESO 2001,552Kg

O bloco de concreto a ser içado contém um volume aproximado de 0,87m³, com massa aproximada de 2000kg.

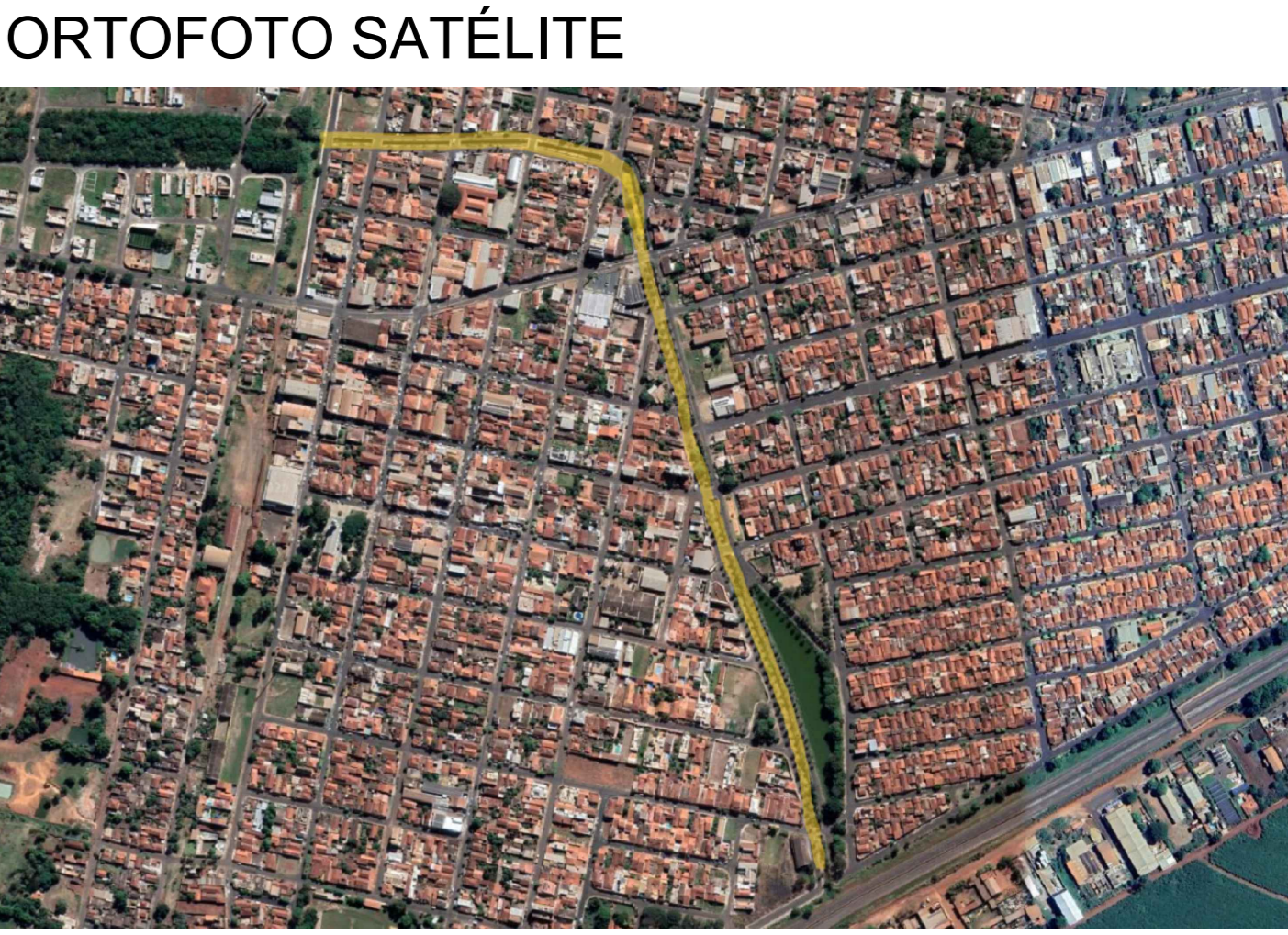

PERSPECTIVA INTERNA DO CANAL

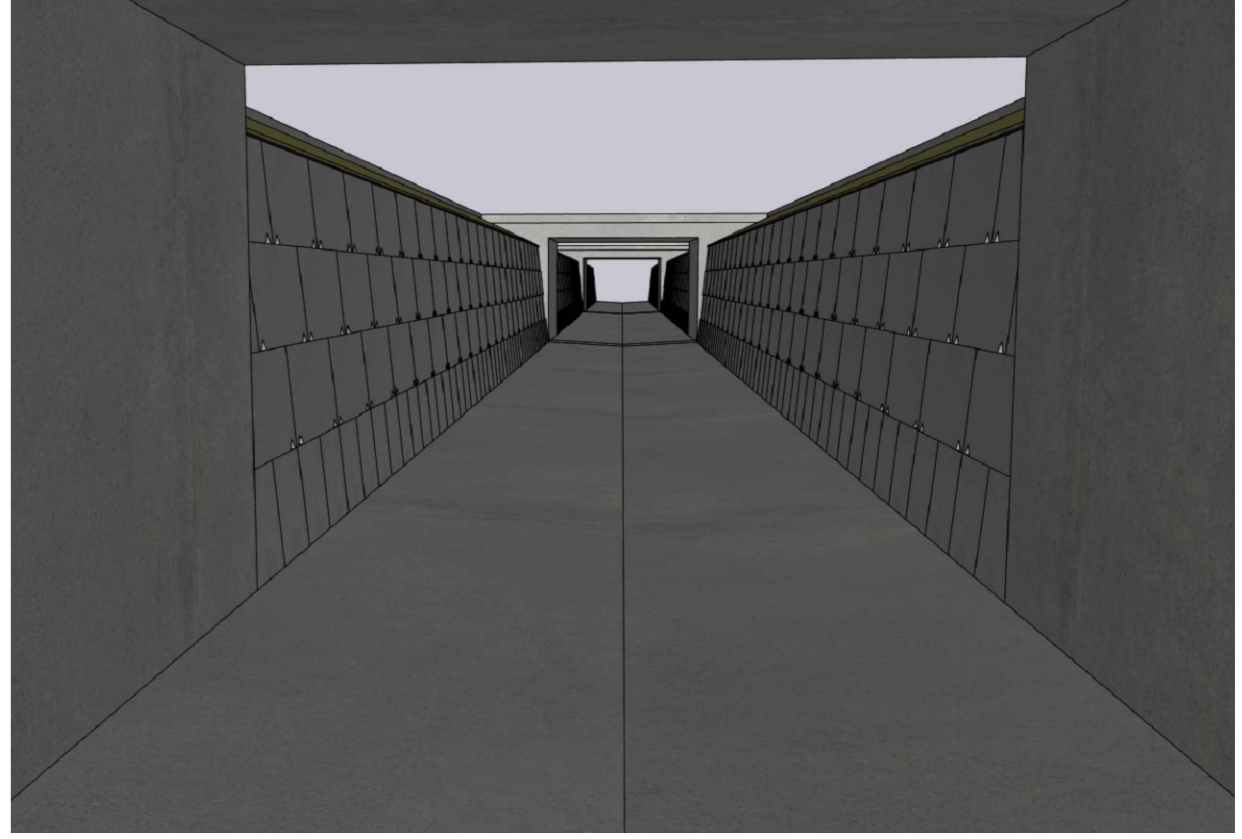

PERSPECTIVA EXTERNA DO CANAL

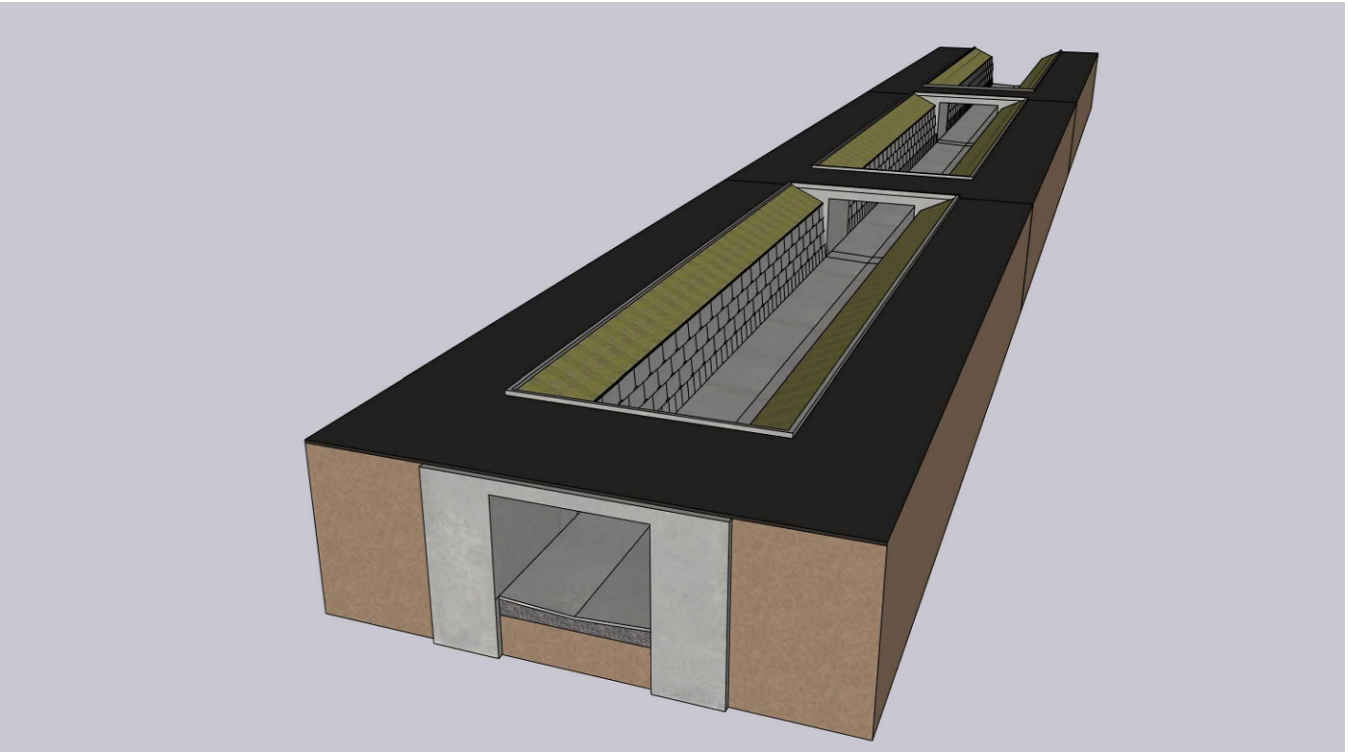

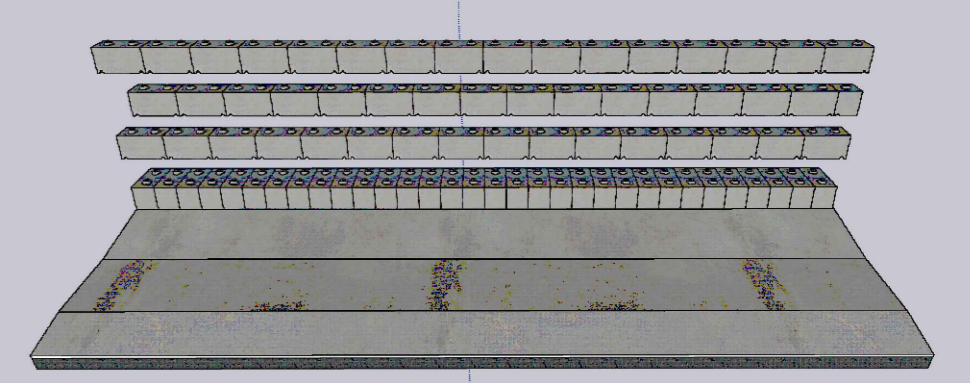

SISTEMA EXECUTIVO - MODULAÇÃO SEÇÃO A

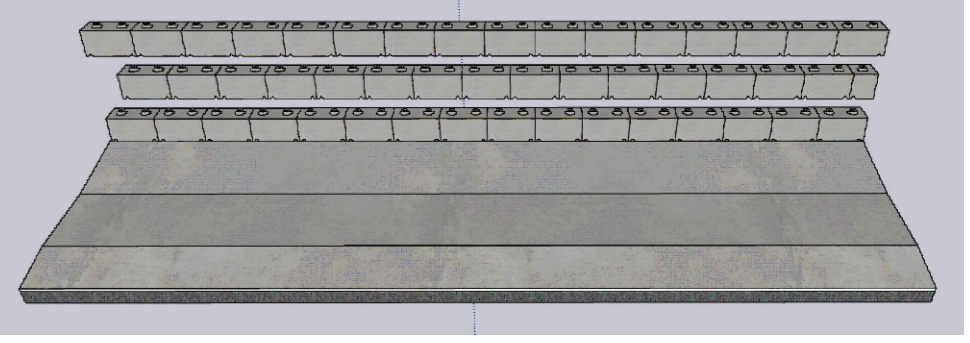

SISTEMA EXECUTIVO - MODULAÇÃO SEÇÃO B

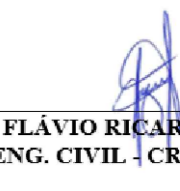

PREFEITURA MUNICIPAL DE BARRINHA - SP		1/1
OBJETO	CANALIZAÇÃO DO CÔRREGO JATOBÁ	
PROPRIETÁRIO	PREFEITURA MUNICÍPL DE BARRINHA - SP	
ENDEREÇO	AV. VEREADOR JÚLIO MARCARI, BAIRRO VILA NOVA BARRINHA CENTRO	
MUNICÍPIO	BARRINHA	
ESTADO	SÃO PAULO	
DATA	24/11/2025	S/ESCALA
ÁREAS:	ASSINATURAS	
COMPR. TOTAL = 650,00m	 FLAVIO RICARDO FUZATTO ENG. CIVIL - CREA - 507.155.696-3	
 WALLACE MARCOS VAZ SANTOS SECRETARIO MUNICIPAL DE OBRAS		